

EXISTING CONDITIONS & EROSION CONTROL PLAN

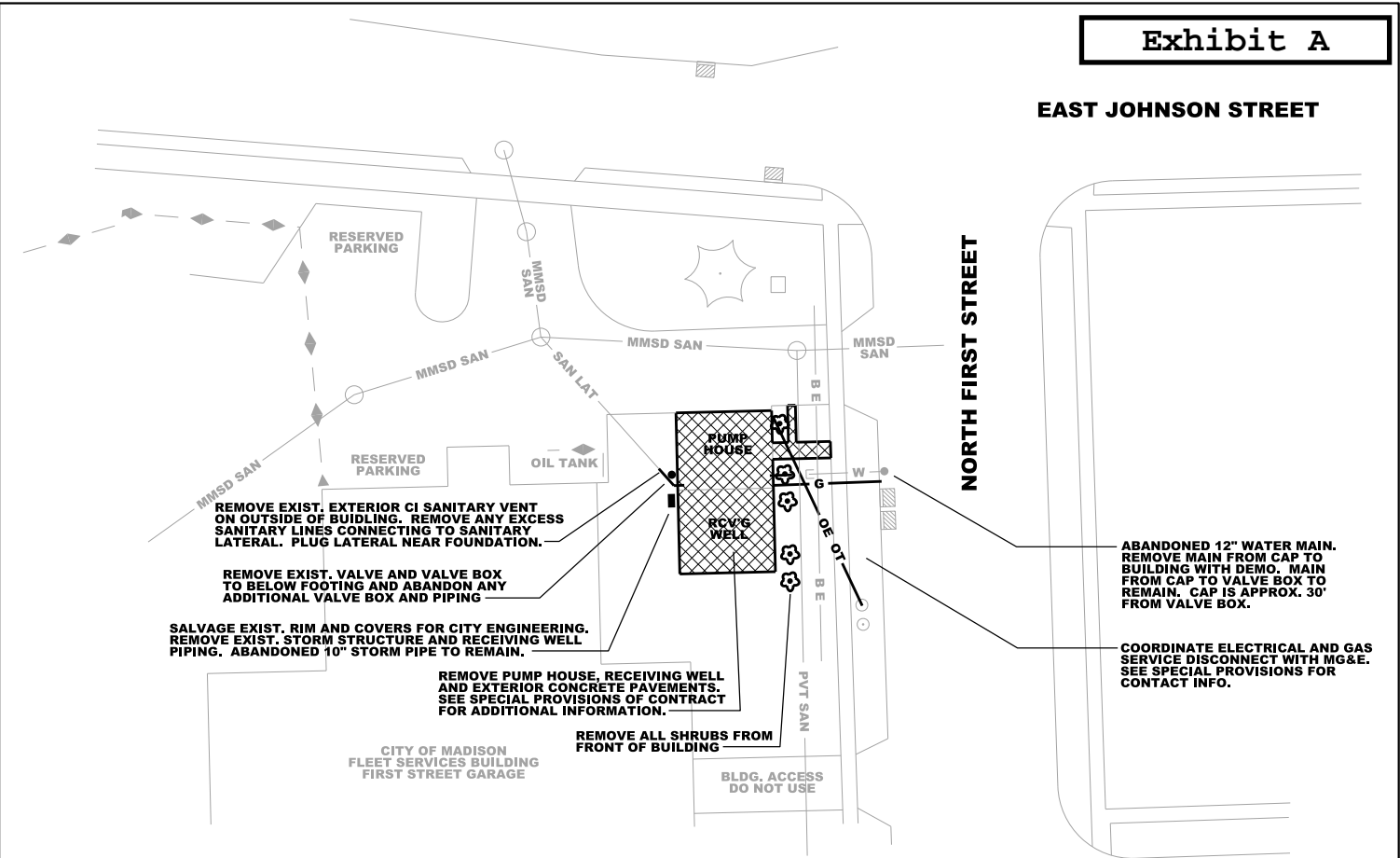

DEMOLITION PLAN

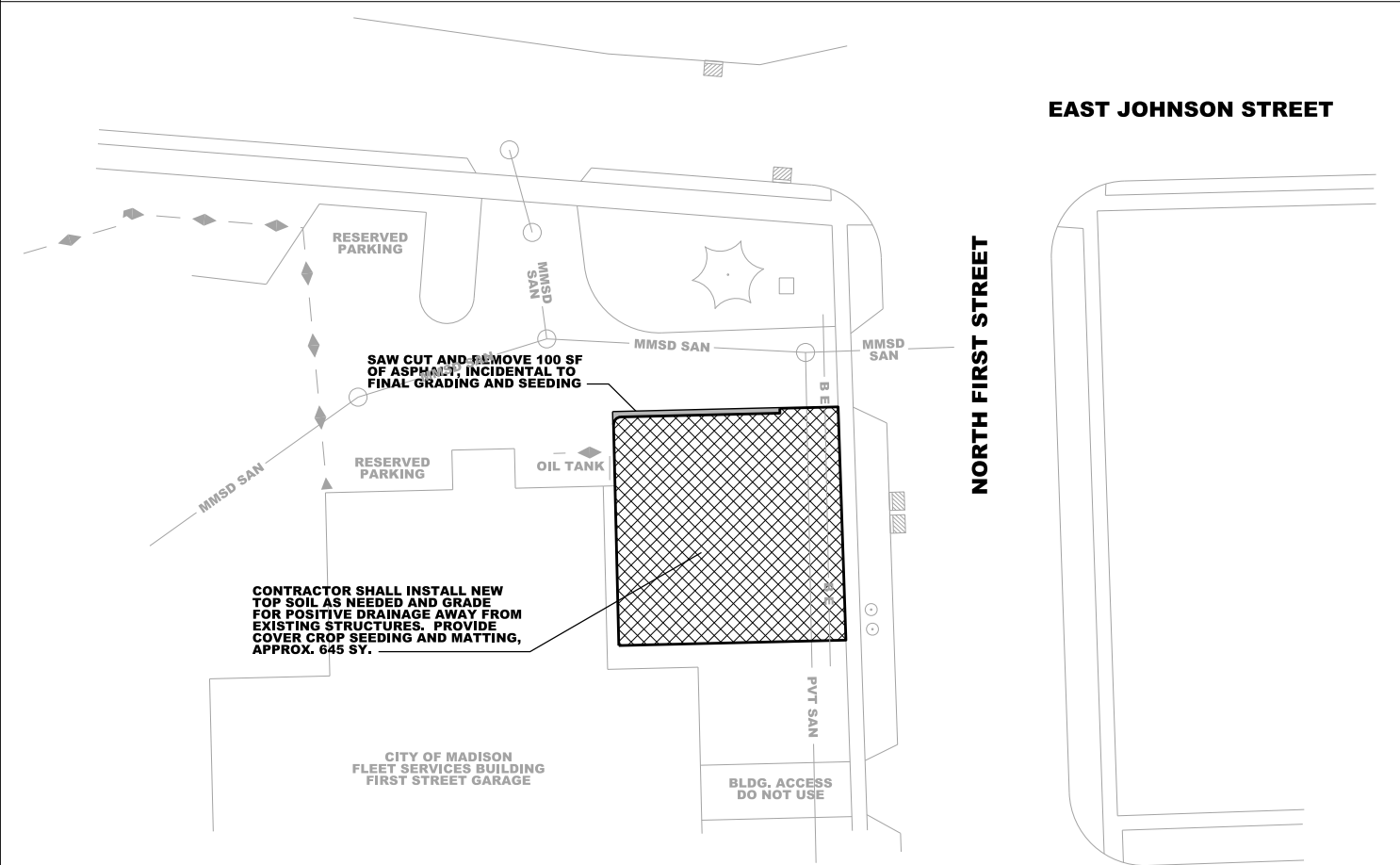

GRADING PLAN

- GENERAL NOTES:**
1. SEE SPECIAL PROVISIONS AND CONTRACT EXHIBITS FOR ADDITIONAL INFORMATION.
 2. CONTRACTOR SHALL BE RESPONSIBLE FOR ANY DAMAGE TO EXISTING ASPHALT PAVING AND MAKING REPAIRS/RESTORATION AS NECESSARY.
 3. CONTRACTOR SHALL PROVIDE PROJECT MANAGER WITH ALL SHIPPING MANIFESTS FOR MATERIALS IN AND OUT OF PROJECT SITE.

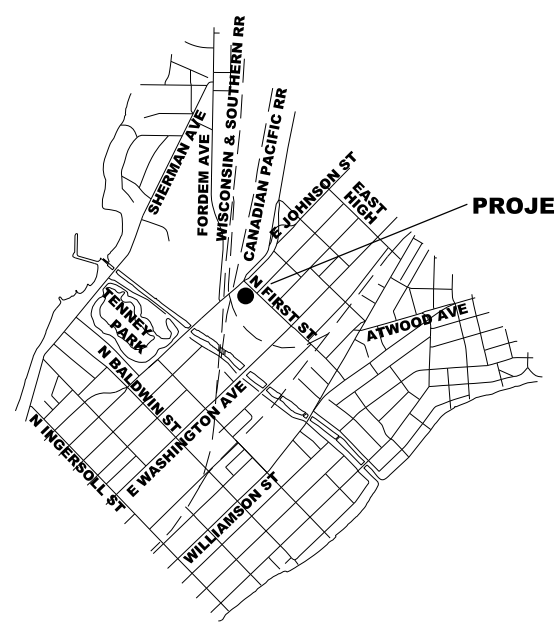

PLANS SCALE:
11 x 17: 1" = 60'

PUBLIC IMPROVEMENT PROJECT APPROVED:	PUBLIC IMPROVEMENT DESIGN APPROVED BY:
RESOLUTION: 18-00555	_____
FILE ID: 52363	CITY ENGINEER
DATED: JULY 24, 2018	_____
BY THE COMMON COUNCIL OF MADISON, WISCONSIN	DATE

**DEMOLITION - 212 N. FIRST ST.
UNIT WELL 3**

**CITY ENGINEERING
MUNIS 10287**

**EROSION CONTROL, DEMOLITION
AND GRADING PLANS**

REMOVE INSCRIPTION STONE, CLEAN OF EXCESSIVE MORTAR, PALLETIZE, BAND AND TRANSPORT TO MADISON WATER UTILITY. CONTACT ADAM WIEDERHEOF AT 266-9121 AWiederhoeft@madisonwater.org

REMOVE FOUR (4) CORNER CAPS, EIGHT (8) CORBEL STONES, ALL PARAPET CAP STONES, AND ALL DENTAL BLOCKS. CLEAN FREE OF EXCESS MORTAR AND LOOSE PAINT. PALLETIZE AND STRETCH WRAP FOR SHIPPING, TRANSPORT TO THE ENGINEERING SERVICE YARD LOCATED AT 4452 SYCAMORE AVE CONTACT CHRIS SCHARF AT 267-1973 CSharf@cityofmadison.com FOR ACCESS.



REMOVE AND DISPOSE OF NINE (9) COMPLETE WINDOW UNITS CONTAINING ASBESTOS.